

Contractors and consultants are not to scale dimensions from this drawing

Reproduced by permission of Ordnance Survey on behalf of HMSO © CROWN COPYRIGHT and database right 2008 All rights reserved Ordnance Survey Licence number AL 1000 22432 Broadway Malyan Limited

The survey information shown on this drawing is based on a topographical survey prepared by a third party and Broadway Malyan Limited accept no responsibility for the accuracy or completeness of the survey.

Drawings to be read in conjunction with the associated Design & Access Statement, associated consultant design team documents & reports and landscape information

Landscape shown is for illustrative purposes only. For detailed landscape information, please refer to the landscape information & documents.

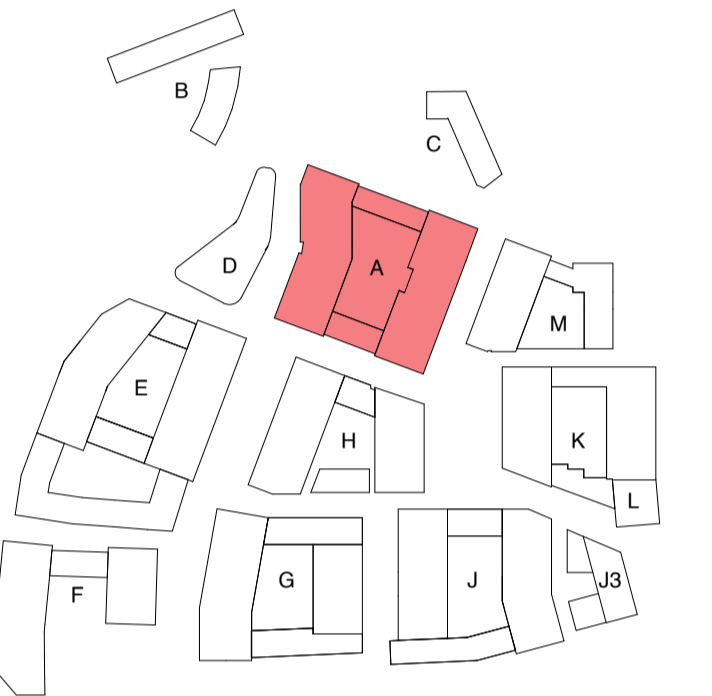
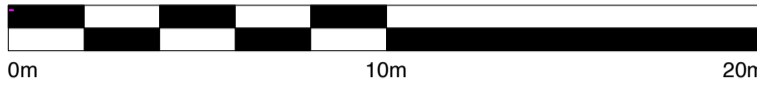

Revision	Date	Drawn By	Description
DD-4	20.01.23		Issued For Planning
DD-3	15.09.22		Issued For Planning
DD-2	15.07.22		Issued For Planning
DD-1	31.03.22		Issued For Planning

  
**BroadwayMalyan<sup>BM</sup>**  
 4 Pear Place  
 London  
 SE1 8BT  
 T: +44 (0)20 7261 4200  
 F: +44 (0)20 7261 4300  
 E: Lon@BroadwayMalyan.com  
[www.BroadwayMalyan.com](http://www.BroadwayMalyan.com)

Client  
**Weston Homes**  
 Project  
**Anglia Square  
 Norwich**  
 Description  
**GA Plan  
 Block A  
 Roof**

Status  
**For Planning**  
 Scale 1:200@A1  
 Drawn By BM  
 Date 20.01.23  
 Job Number 35301  
 Drawing Number ZA-07-DR-A-03-0107  
 Revision D0-4