

Ecology Solutions Limited
 Cokenach Estate
 Barkway
 Royston
 Hertfordshire
 SG8 8DL

+44(0)1763 848084
 east@ecologysolutions.co.uk
 www.ecologysolutions.co.uk



5984: ANGLIA SQUARE, NORWICH

BIODIVERSITY NET GAIN UPDATE MARCH 2023

1. Ecology Solutions prepared a Biodiversity Net Gain Assessment of the proposed development in January 2023, the results of which are summarised in the table below:

Baseline	Habitat Units	1.36
	Hedgerow Units	0.04
	River Units	0
Post-intervention	Habitat units	2.50
	Hedgerow Units	1.25
	River Units	0
Total Net Unit Change	Habitat units	1.15
	Hedgerow Units	1.21
	River Units	0
Total Net Percentage Gain	Habitat Units	84.78%
	Hedgerow units	3280.11%
	River Units	N/A

2. Since that time, some limited amendments to the landscape proposals have been undertaken, with Revision D updating Revision C.
3. In order to increase the width of pedestrian paths along St Georges Street alongside the cycle path the soft landscaped areas have been reconfigured, but the total amount of soft landscaped area (and planting types / species within them) and number of trees remain the same overall as summarised in the table below and shown in comparison plans appended to this note.

	Revision C	Revision D
Soft Landscaped Area	764 sqm	778 sqm (+14.8)
Hedging	177 sqm	176.5 sqm (-0.5)
Trees	33	33

4. While these amendments would affect the Biodiversity Net Gain calculation, the overall effect is considered to be negligible given the limited extent of the changes. Moreover, the extent of net gain as set out in the January assessment is such that limited amendments to the landscaping will make no significant difference to the high level of gain to be delivered. On this basis the formal assessment has not been updated.

Summary of changes, Rev C > Rev D:

In order to increase the width of pedestrian paths along St Georges Street alongside the cycle path the soft landscaped areas have been reconfigured, but the total amount of soft landscaped area (and planting types/species within them) and number of trees remain the same overall as summarised in the table and shown in the following comparison plans.

	Rev C	Rev D
Soft Landscaped Area	764 sqm	778.8 sqm (+14.8)
Hedging	177 sqm	176.5 sqm (-0.5)
Trees	33	33

Rev C Landscape

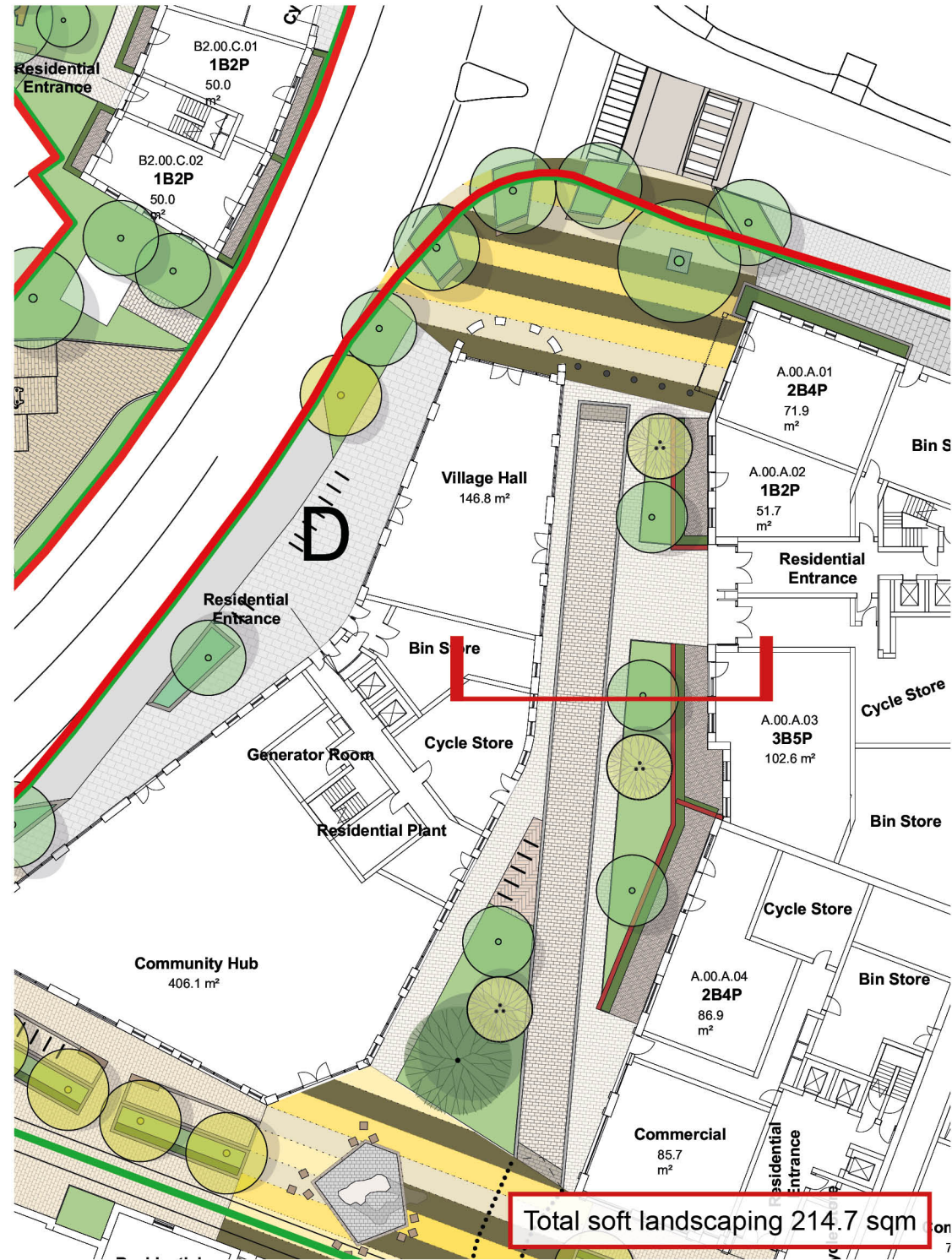

Rev D Landscape

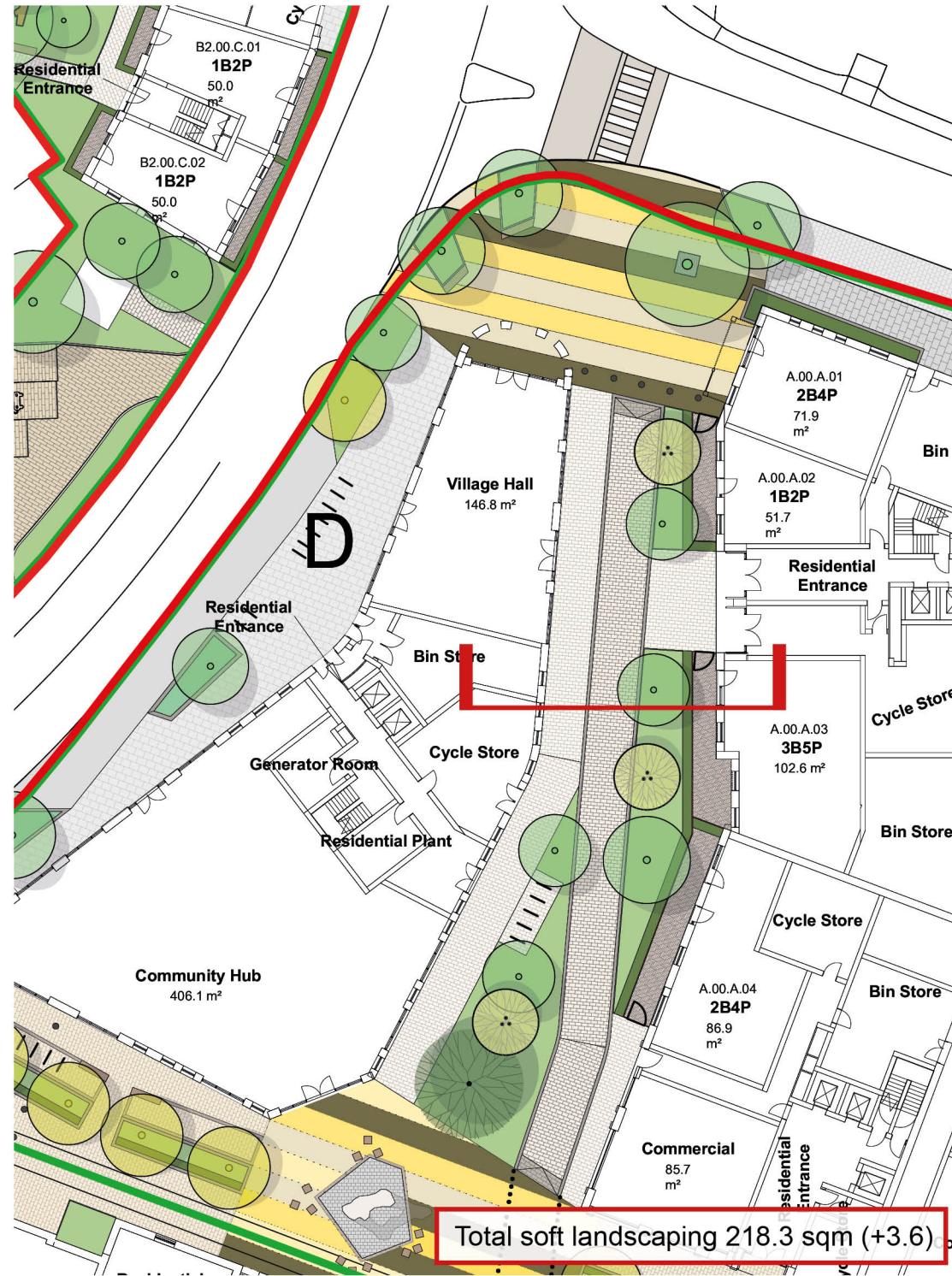

St George's Street, North

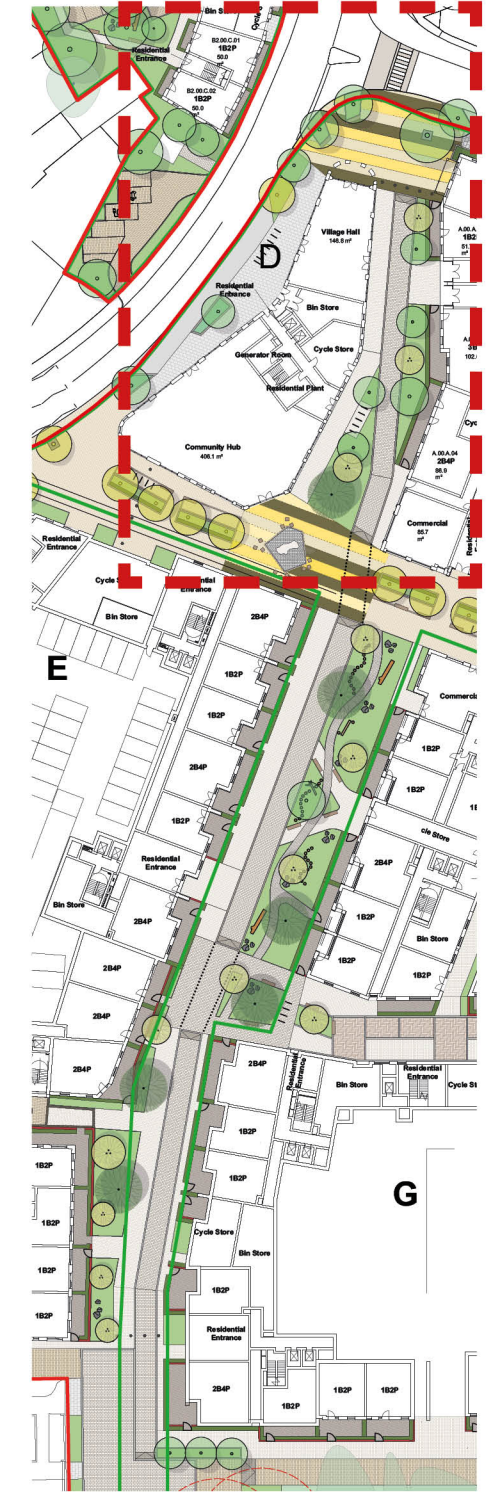

Indicative sections

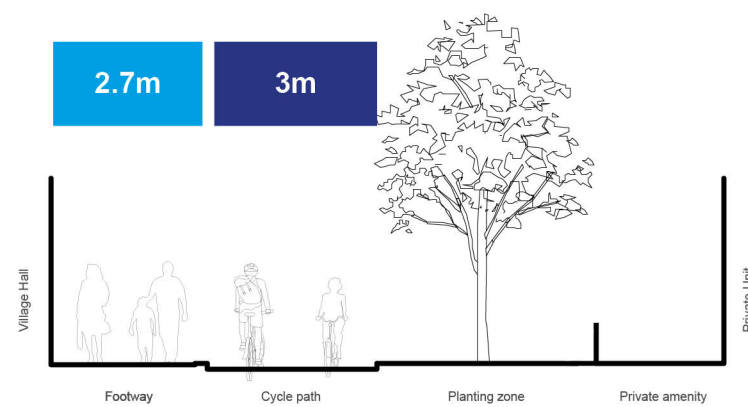
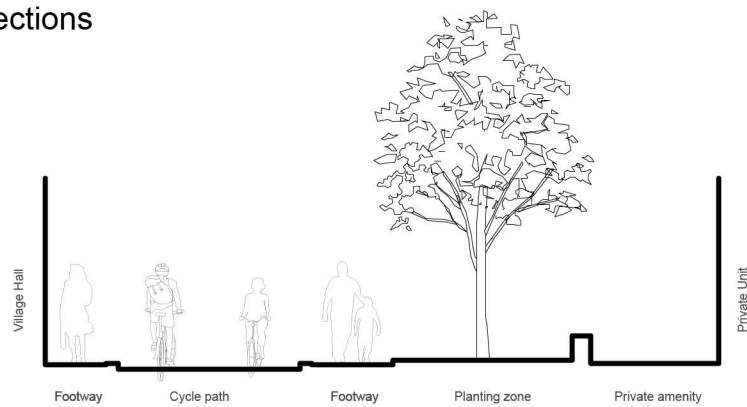

Rev C Landscape

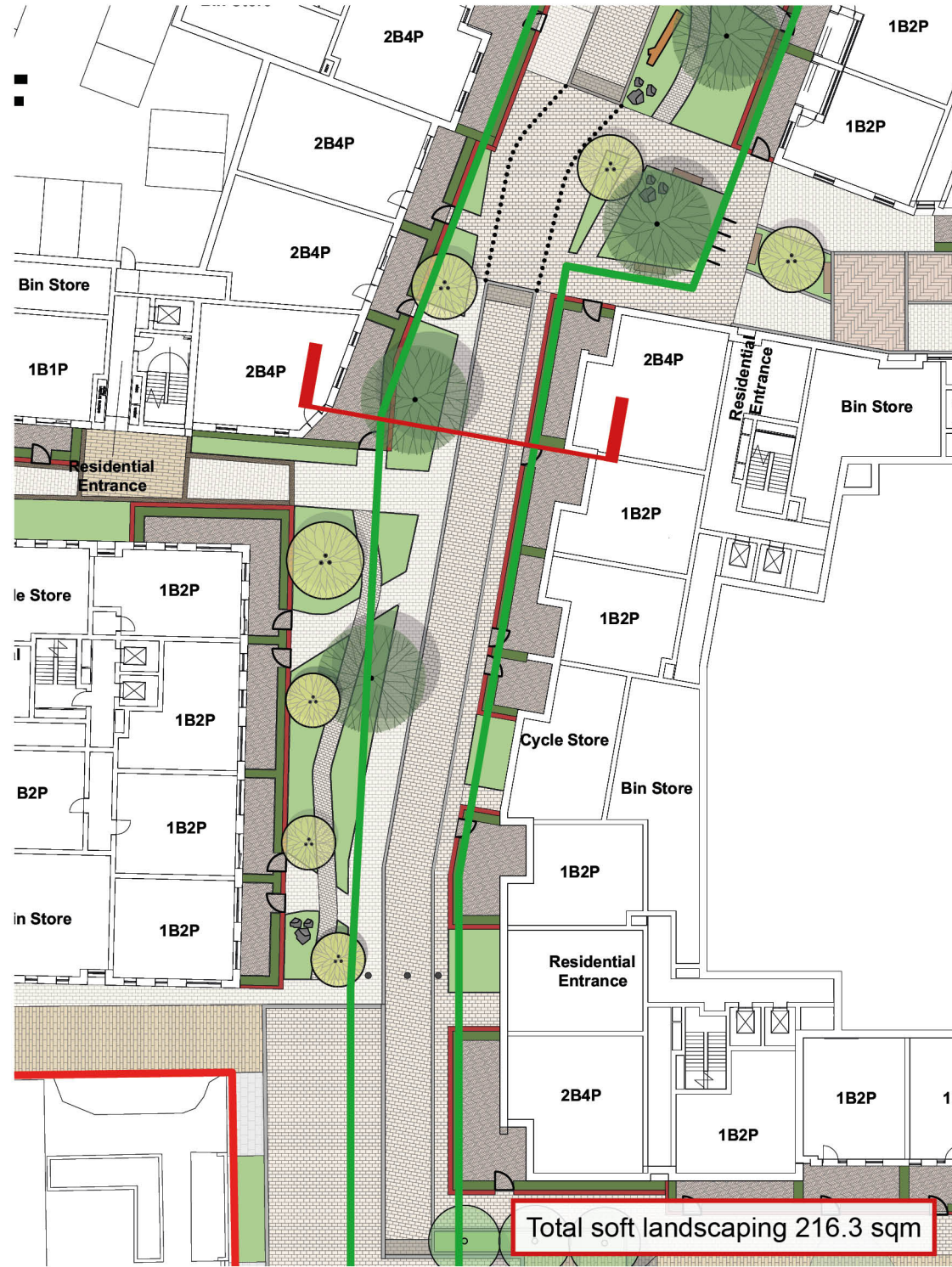

Rev D Landscape

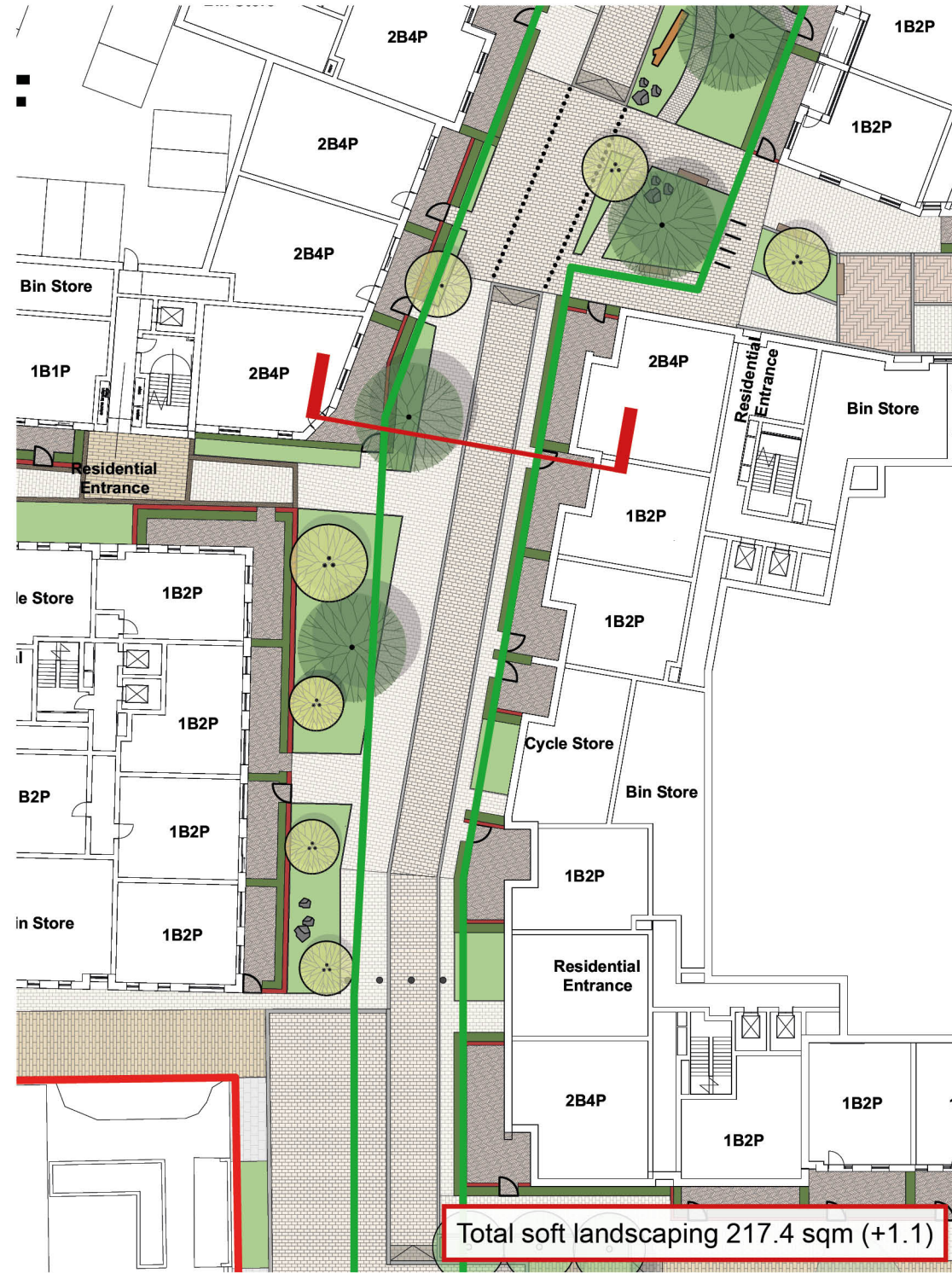

St George's Street, South

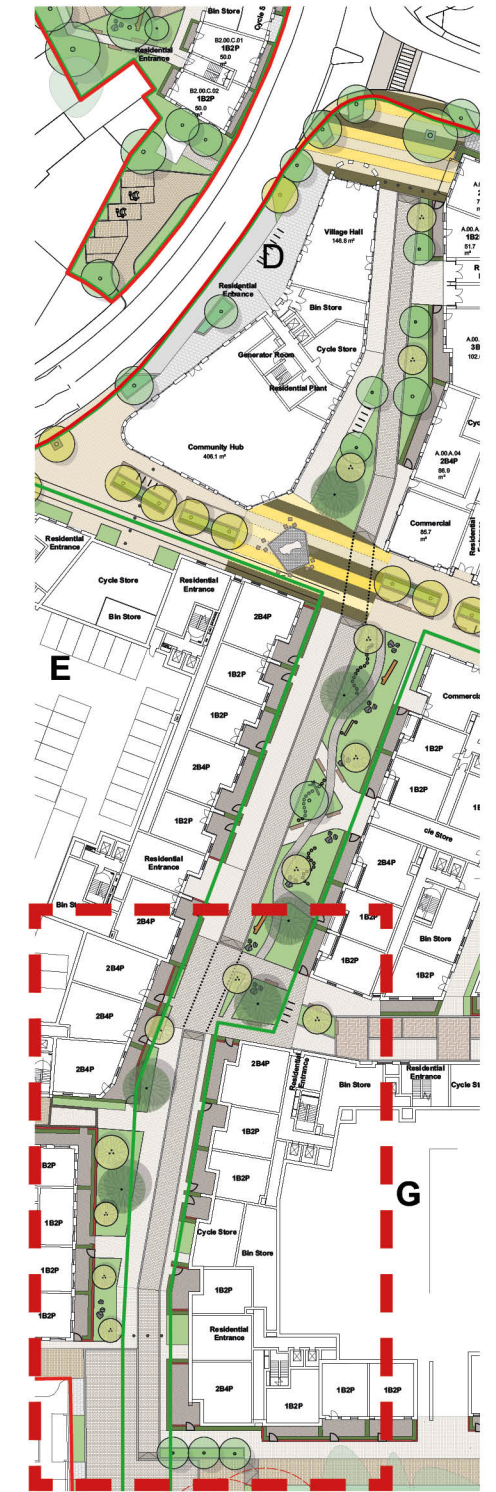

Indicative sections

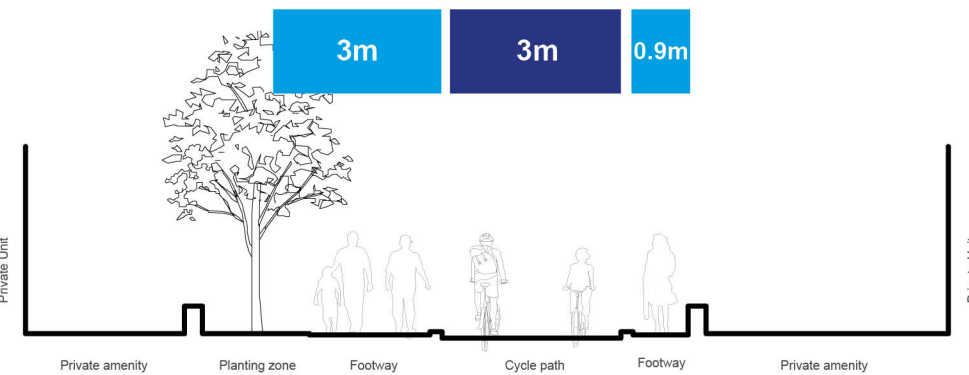
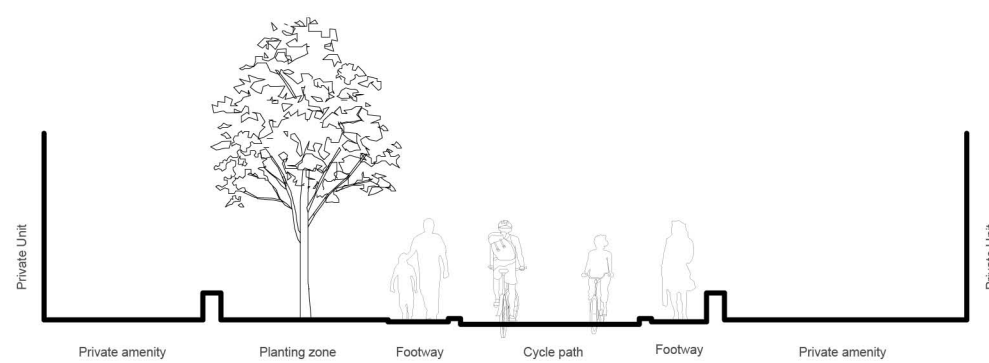



ECOLOGYSOLUTIONS

Part of the **ES Group**

Ecology Solutions Limited | Cokenach Estate | Barkway | Royston | Hertfordshire | SG8 8DL

01763 848084 | east@ecologysolutions.co.uk | www.ecologysolutions.co.uk