

THIS DRAWING IS COPYRIGHT PROTECTED AND MAY NOT BE REPRODUCED IN WHOLE OR PART WITHOUT WRITTEN AUTHORITY FROM THE OWNER.

- NOTES:**
- Do not scale from this drawing.
 - Always work to noted dimensions.
 - All dimensions are in millimetres unless otherwise stated.
 - All setting out, levels and dimensions to be agreed on site.
 - The dimensions of all materials must be checked on site before being laid out.
 - This drawing must be read with the relevant specification clauses and detail drawings.
 - Order of construction and setting out to be agreed on site.

KEY

- BOUNDARIES**
- HYBRID APPLICATION BOUNDARY
 - LAND OWNED BY CT
 - DETAIL APPLICATION BOUNDARY

HARDWORKS

- BITUMINOUS MACADAM TYPE S1**
Location: Highways and vehicular cross-overs throughout
Material: Bituminous macadam to match existing highways
Colour: Black. Surface treatment to match existing
- FEATURE CONCRETE BLOCK PAVING TYPE S2.1**
Location: Main pedestrian routes throughout.
Material: Small-format concrete block paving
Size: 200(L) x 100(W)mm
Colour: Buff mix
Laid: Unbound construction. Stretcher bond
- CONCRETE BLOCK PAVING TYPE S3.1**
Location: Secondary pedestrian routes
Material: Small-format pre-cast concrete block paving with exposed natural stone aggregate
Size: 200(L) x 100(W)mm
Colour: Warm Grey mix
Laid: Unbound construction. Stretcher bond
- CONCRETE BLOCK PAVING TYPE S3.2**
Location: Cycle/servicing routes and lay-bys
Material: Small-format pre-cast concrete block paving with exposed natural stone aggregate
Size: 200(L) x 100(W)mm
Colour: Grey mix
Laid: Unbound construction. Stretcher bond
- CONCRETE BLOCK PAVING TYPE S3.3**
Location: Raised table ramps and parking bays
Material: Small-format pre-cast concrete block paving with exposed natural stone aggregate
Size: 200(L) x 100(W)mm
Colour: Dark Grey
Laid: Unbound construction. Stretcher bond
- CONCRETE BLOCK PAVING TYPE S4.1**
Location: Adopted footpaths
Material: Small-format pre-cast concrete block paving
Size: 100(L) x 100(W)mm
Colour: Grey mix
Laid: Unbound construction. Stretcher bond
- FEATURE CONCRETE BLOCK PAVING TYPE S5**
Location: Feature ground-plane to pedestrian routes & residential courtyards.
Material: Tumbled pre-cast concrete block paving with exposed natural stone aggregate
Size: 200(L) x 100(W)mm
Colour: Buff/grey mix
Laid: Unbound construction. Stretcher bond
- FEATURE GEOMETRIC CONCRETE BLOCK PAVING TYPE S6**
Location: Anglia Square central space
Material: Pre-cast concrete block paving with exposed aggregate surface. Kellen or equal approved.
Size: 200x300mm
Colour: Four shades of yellow and Black Contrasting
Laid: Triangular geometric shapes

FURNITURE

- TIMBER BENCH TYPE F1**
Location: Throughout. Stand-alone and integrated with planters
Material: Steel frame with hardwood seating surfaces
Other: Integrated back and arm rests
- CYCLE STANDS TYPE F3**
Location: Throughout
Material: Sheffield hoop style cycle stands
Finish: Galvanised and powder coated RAL TBC
- PICNIC TABLES TYPE F4**
Location: Anglia Square
Material: Sheffield hoop style cycle stands
Finish: Galvanised and powder coated RAL TBC
- INFORMAL PLAY TYPE F5**
Location: In areas of soft landscape
Material: Informal play equipment such as stepping stones, logs, boulders etc
- PUBLIC ART TYPE F7**
Location: Botolph Street
Specification: Design subject to consultation with local residents and artists
- BOLLARDS TYPE F9**
Location: As shown
Specification: Bollards to prevent vehicle access. Removable bollards provided on fire tender / maintenance routes
- IN GROUND STUDS TYPE F11**
Location: As shown
Specification: Stainless Steel Studs with embossed cycle motif to demarcate cycle route in cross over areas.
- LOW BRICK WALL**
Location: Throughout the site on the residential courtyards.
Material: Solid brick wall
Other: Metal railing on the top

SOFTWORKS

- LAWNS**
Species-rich grassland
- PLANTING AREA**
Refer to softworks drawing and report for detailed breakdown of planting types/logos
- MIXED NATIVE HEDGING TYPE P6**
Mixed species native hedging
Maintained at 1.2m(h)
- TREE PLANTING TYPE T1**
Refer to schedule for specification
- MULTI-STEM TREE PLANTING TYPE T2**
Refer to schedule for specification
- EXISTING TREE PLANTING TYPE T3**
To be retained
- EXISTING TREE TO BE REMOVED**

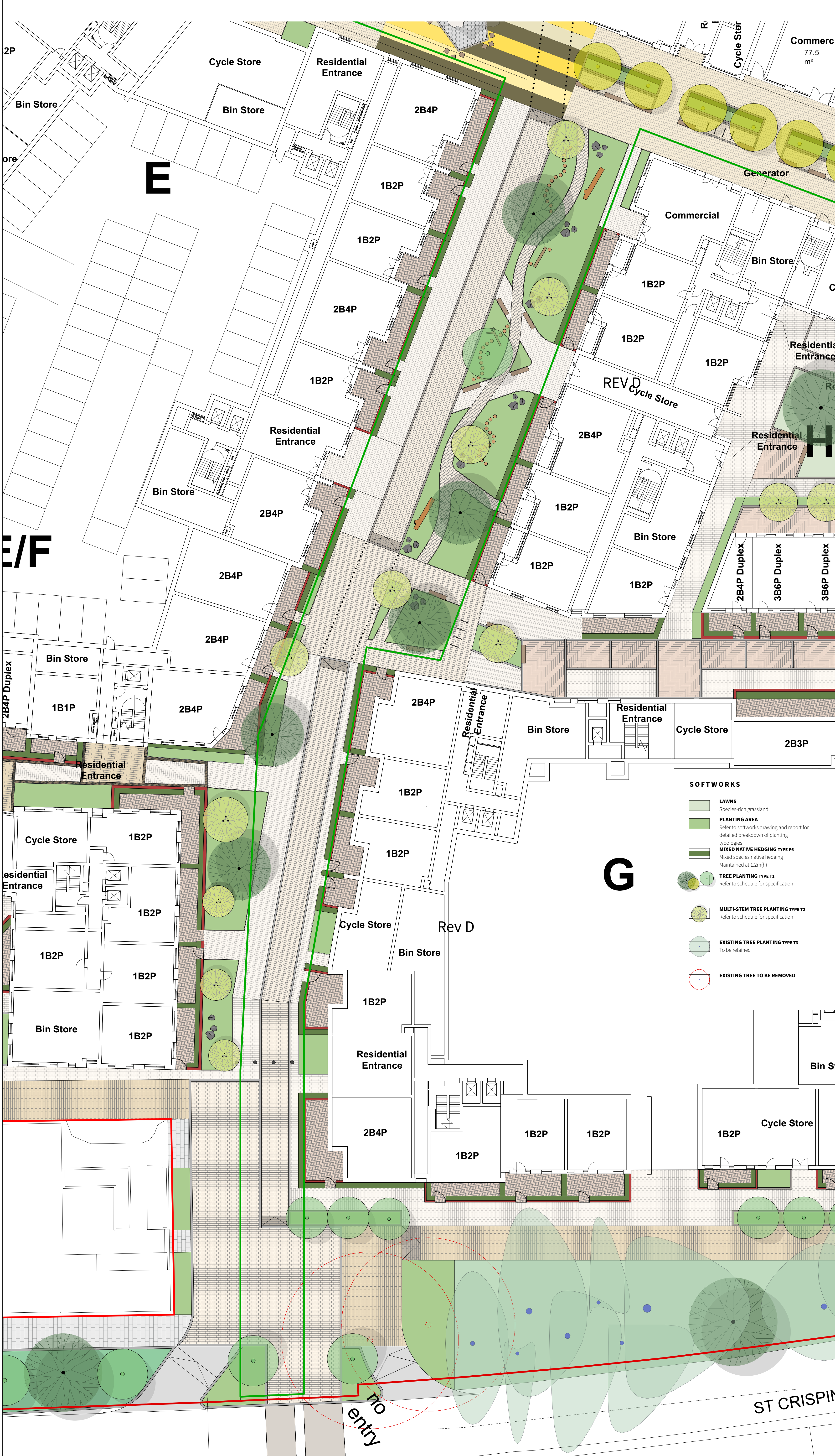

| Revision | Date | Description | Drawn | Appr'd. |
|----------|----------|-------------|-------|---------|
| P06 | 20.03.23 | PLANNING | JV | DF |

Plantit I.E. Limited
 E: info@plantit-ie.com W: plantit-ie.com
MANCHESTER
 2 Back Grafton St, Altrincham, WA14 1DY
 T: 0161 928 9281
LEEDS
 No.1 Aire Street, Leeds Station, Leeds, LS1 4PR
 T: 0113 824 6413
LIVERPOOL
 Tempest 5.3, 12 Tithebarn Street, Liverpool, L2 2DT
 T: 0151 363 1230
LONDON
 Unit 6 Waterside, 44-48 Wharf Road, London, N1 7UX
 T: 0207 253 5678
STANDISH
 Standish Gatehouse, Stonehouse, Gloucestershire, GL10 3BZ
 T: 0145 360 7080

| | |
|-------------|-------------------------------------|
| Client | Weston Homes |
| Project | Anglia Square |
| Drg Title | St Georges Gardens Detail Area_RevD |
| Created on | 01.04.2022 |
| Created by | JV |
| Approved by | DF |
| Scale | 1:200 |
| Size | A1 |
| Workstage | Planning |
| Drg No. | ANG-PLA-XX-DR-L-8002 |
| Suitability | S4 |
| Revision | P06 |