

4 03/Fir  
1 : 500

8 07/Fir  
1 : 500

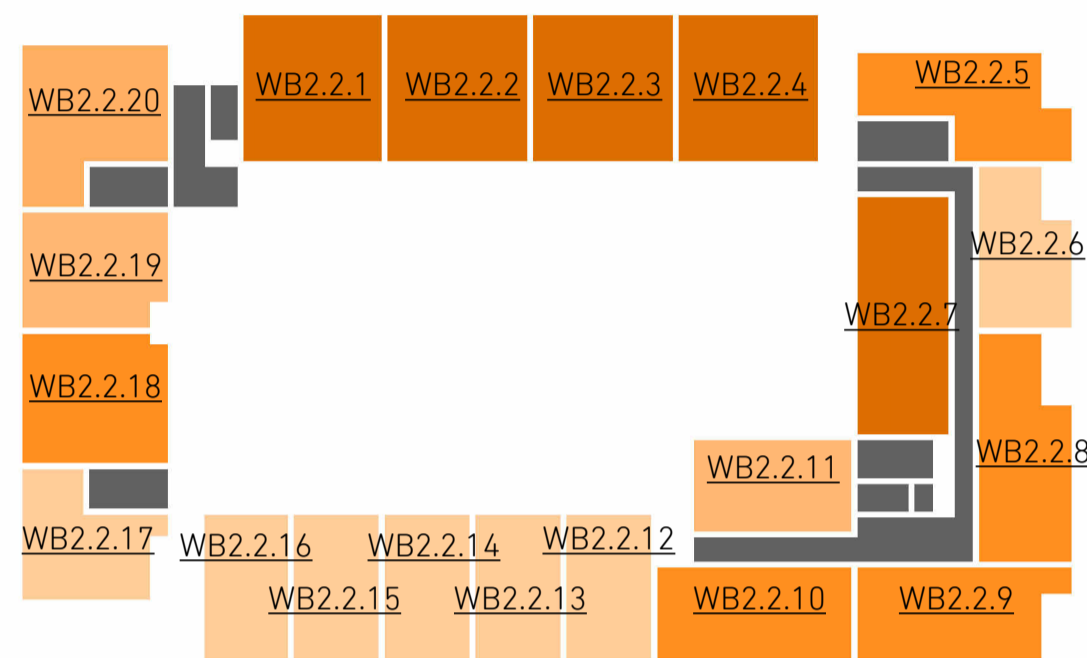

3 02/Fir  
1 : 500

7 06/Fir  
1 : 500

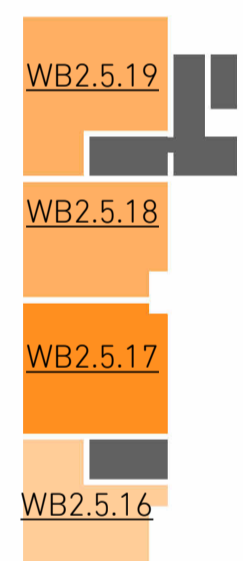
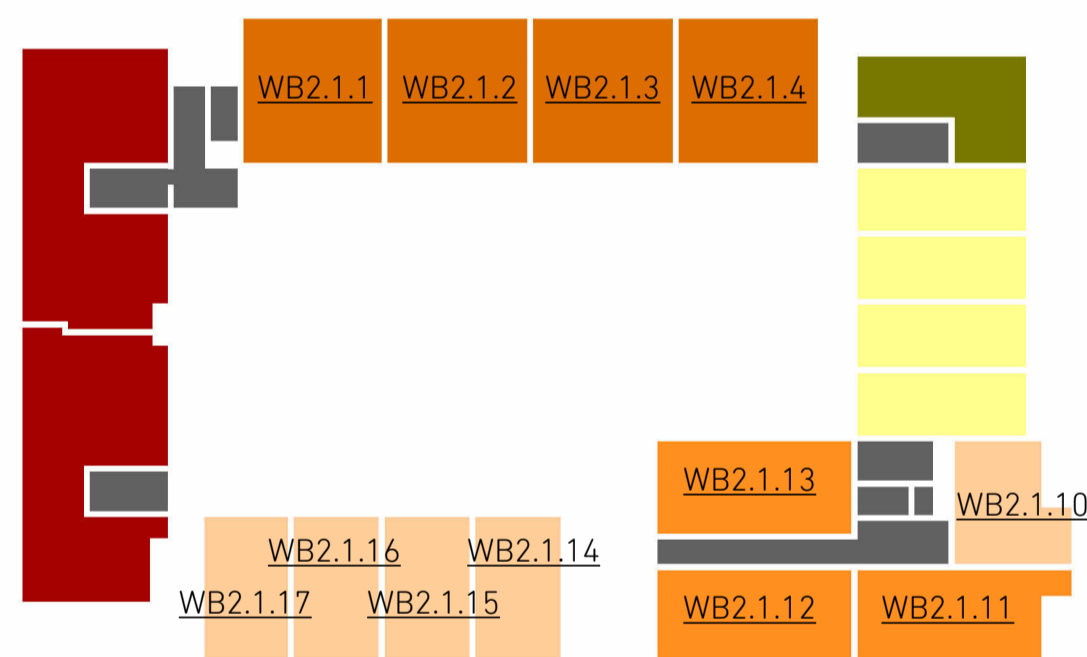

2 01/Fir  
1 : 500

6 05/Fir  
1 : 500

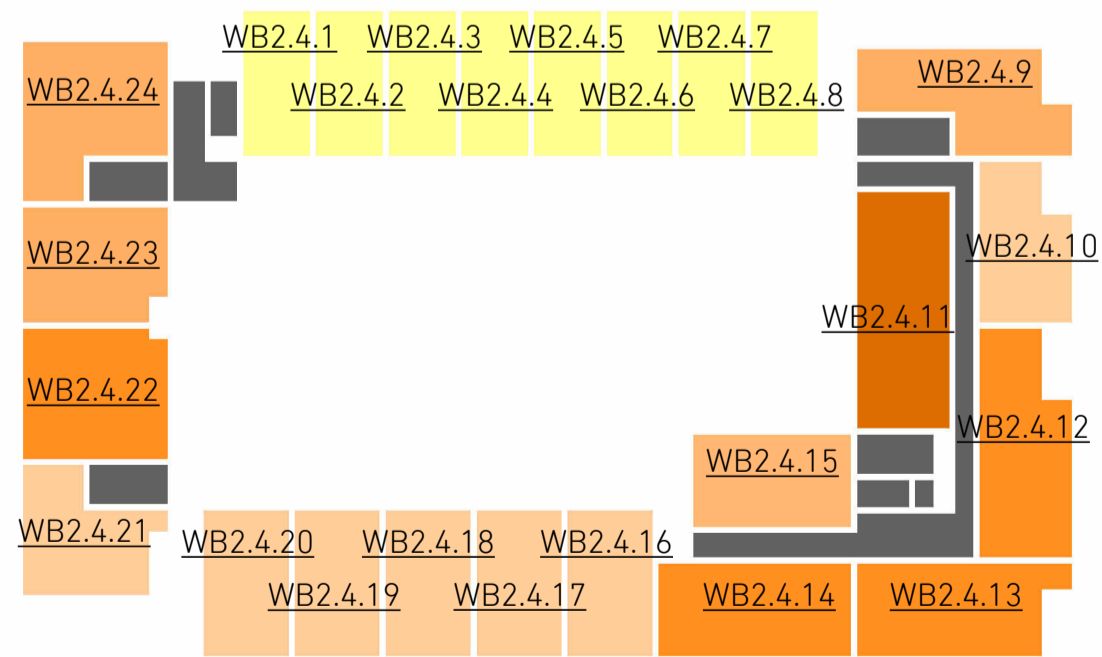
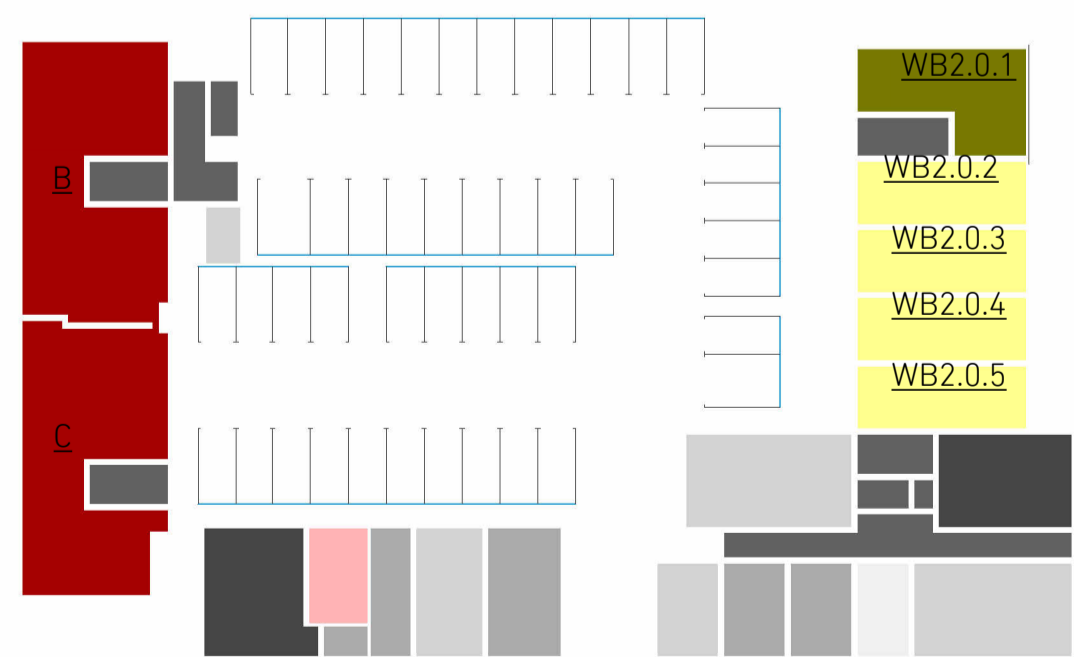

1 00/Fir  
1 : 500

5 04/Fir  
1 : 500

Units by Type		
Level	Name	Count
00/Fir_CLEAN	Duplex_2B/4P_M4(2)_Lower	4
00/Fir_CLEAN	Duplex_3B/6P_M4(2)_Lower	1
00/Fir_CLEAN: 5		
01/Fir1	Flat_1B/2P_M4(2)	5
01/Fir1	Flat_3B/4P_M4(2)	3
01/Fir1	Flat_3B/5P_M4(2)	4
01/Fir1: 12		
02/Fir1	Flat_1B/2P_M4(2)	7
02/Fir1	Flat_2B/3P_M4(2)	2
02/Fir1	Flat_2B/4P_M4(2)	1
02/Fir1	Flat_3B/4P_M4(2)	5
02/Fir1	Flat_3B/5P_M4(2)	5
02/Fir1: 20		
03/Fir1	Flat_1B/2P_M4(2)	7
03/Fir1	Flat_2B/3P_M4(2)	2
03/Fir1	Flat_2B/4P_M4(2)	1
03/Fir1	Flat_3B/4P_M4(2)	5
03/Fir1	Flat_3B/5P_M4(2)	5
03/Fir1: 20		
04/Fir1	Duplex_2B/4P_M4(2)_Lower	8
04/Fir1	Flat_1B/2P_M4(2)	7
04/Fir1	Flat_2B/3P_M4(2)	1
04/Fir1	Flat_2B/4P_M4(2)	3
04/Fir1	Flat_3B/4P_M4(2)	4
04/Fir1	Flat_3B/5P_M4(2)	1
04/Fir1: 24		
05/Fir	Duplex_4B/8P_M4(2)_Lower	3
05/Fir	Flat_1B/2P_M4(2)	2
05/Fir	Flat_2B/4P_M4(2)	2
05/Fir	Flat_3B/4P_M4(2)	3
05/Fir	Flat_3B/5P_M4(2)	1
05/Fir: 11		
06/Fir	Flat_1B/2P_M4(2)	1
06/Fir	Flat_2B/3P_M4(2)	1
06/Fir	Flat_2B/4P_M4(2)	1
06/Fir	Flat_3B/4P_M4(2)	1
06/Fir: 4		
07/Fir	Flat_1B/2P_M4(2)	1
07/Fir	Flat_2B/4P_M4(2)	2
07/Fir	Flat_3B/4P_M4(2)	1
07/Fir: 4		
Grand total: 100		

Commercial Area	
Name	Area
E_Restaurant	
E_Restaurant	145.7 m²
E_Restaurant	145.7 m²
E_Restaurant	156.5 m²
E_Restaurant	158.1 m²
Grand total: 4	605.9 m²

Cycle Spaces
170

Refuse Schedule		
Type	Volume	Litres
Wheelie bin - 1100 litre - Recycling	25.24 m³	24200
Wheelie bin - 1100 litre - Refuse	17.21 m³	16500

Deal Ground Unit Type

- Common\_Circulation
- Duplex\_2B/4P\_M4(2)\_Upper
- Duplex\_4B/8P\_M4(2)\_Lower
- Flat\_1B/2P\_M4(2)
- Flat\_2B/4P\_M4(2)
- Flat\_3B/4P\_M4(2)
- Flat\_3B/5P\_M4(2)

Deal Ground Unit Type

- Common\_Bike Store
- Common\_Bin Store
- Common\_Circulation
- Common\_Entrance
- Common\_Plant Room
- Duplex\_2B/4P\_M4(2)\_Lower
- Duplex\_3B/6P\_M4(2)\_Lower
- E\_Bins
- E\_Restaurant

1. All Dimensions in mm unless stated otherwise.  
 2. Do not scale this drawing. All dimensions to be verified by the contractor before work is commenced.  
 3. Architect to be notified immediately if any discrepancies are found.  
 4. All shop drawings to be approved by Architect before work commences.  
 5. All details to be in accordance with relevant British Standards and manufacturers recommendations and specification.  
 6. This drawing is the property of Stolton Studio Ltd. copyright reserved. This drawing is not to be copied, reproduced, retained or disclosed to any unauthorised person either wholly or in part without the specific consent in writing of Stolton Studio.  
 7. All work to be carried out by a competent contractor working, where appropriate, to an agreed method statement.  
 8. Please note that all details shown on GAs are generated automatically by the computer software, and are not to be used for reference or construction.  
 9. For all interface details, please refer to 1:5 drawings.  
 10. This drawing is produced based on Survey information by others and Stolton Studio Ltd take no responsibility for the accuracy of this information.

Notes  
 Please note that all details shown on GAs are generated automatically by the computer software, and are not to be used for reference or construction. For all interface details, please refer to 1:5 drawings.

Rev	Date	Description
D	11/07/23	Reserved Matters Amendment
C	19/06/23	Reserved Matters Issue
B	03/05/23	Amendments
A	19/04/23	DRAFT Issue

Drawing Title: W_Block 2_Area Plans, 00_Fir-07_Fir	Scale: 1 : 500 @ A1
Project No.: 055	First Issue: 19/06/23
Project Name: Dealground and May Gurney	Status: Stage 3
Project Address: Bracondale, Norwich	Drawing No.: 055-S3-(WB2.ZZ)-A012
	Rev.: D

