

4 03/Flr
1 : 500

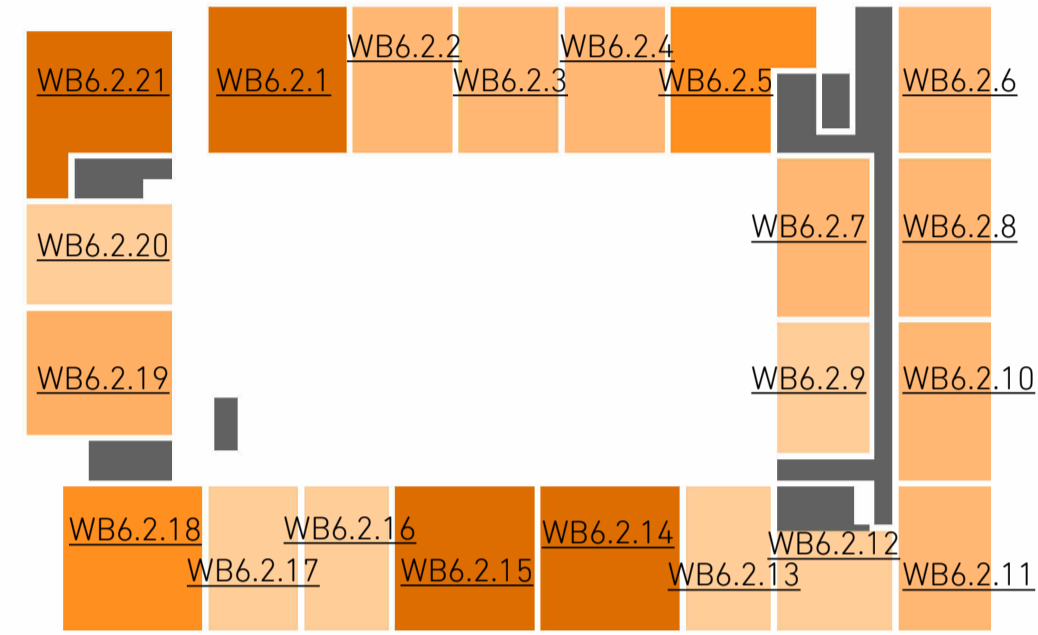

3 02/Flr
1 : 500

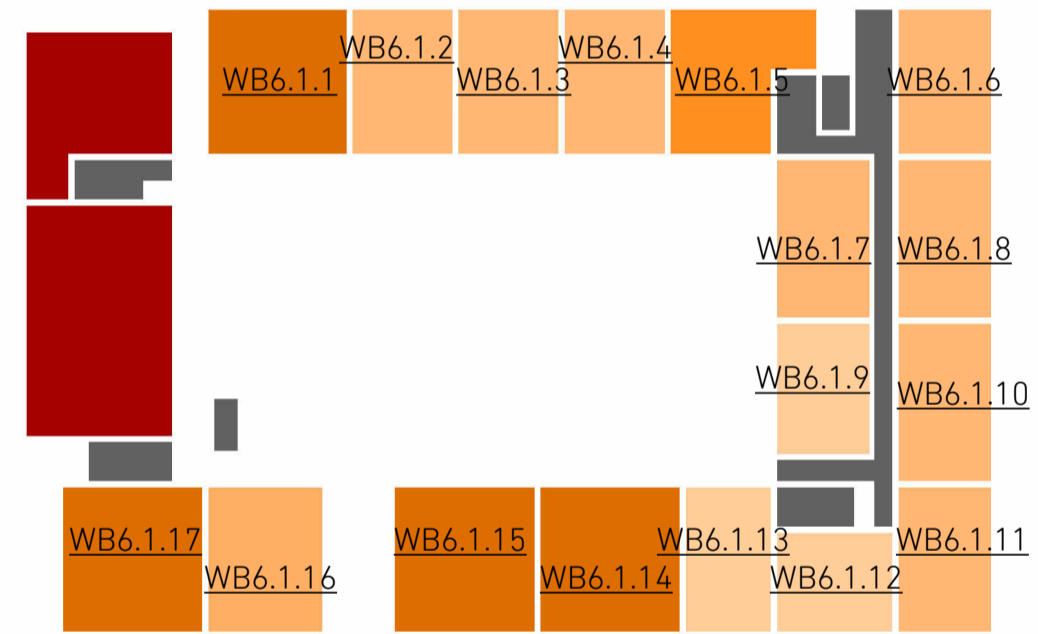

2 01/Flr
1 : 500

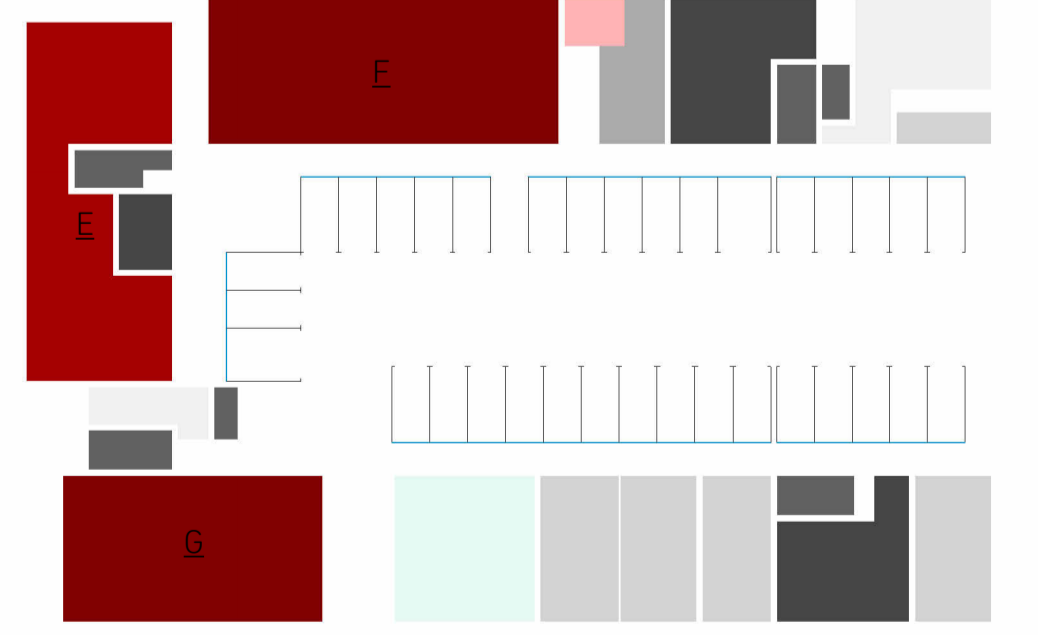

1 00/Flr
1 : 500

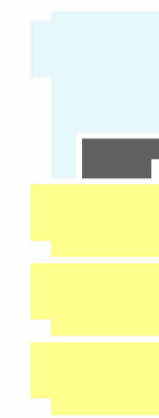

7 06/Flr
1 : 500

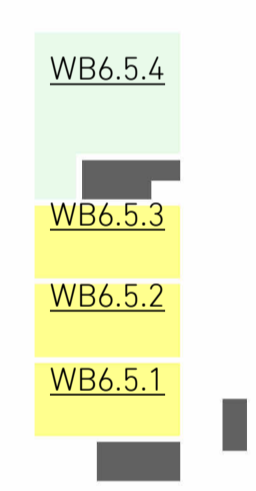

6 05/Flr
1 : 500

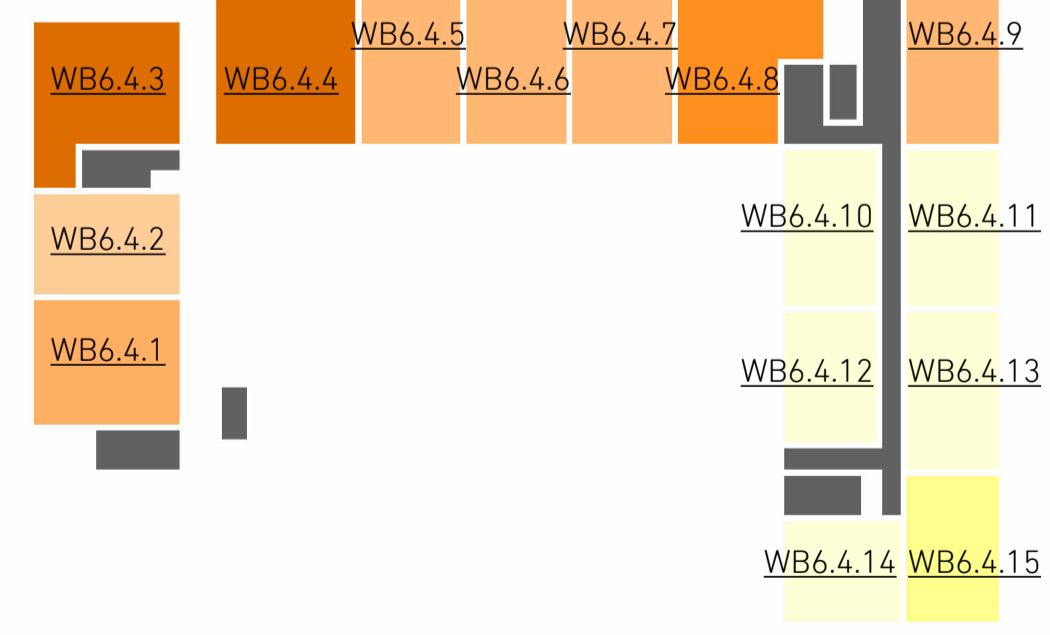

5 04/Flr
1 : 500

Unit by type		
Level	Name	Count
00/Flr	E_Bins	1
00/Flr	E_Restaurant	1
00/Flr	E_Shop	2
00/Flr: 4		
01/Flr	E_Restaurant	2
01/Flr	Flat_1B/2P_M4(2)	3
01/Flr	Flat_2B/3P_M4(2)	8
01/Flr	Flat_2B/4P_M4(2)	1
01/Flr	Flat_3B/4P_M4(2)	1
01/Flr	Flat_3B/5P_M4(2)	4
01/Flr: 19		
02/Flr	Flat_1B/2P_M4(2)	6
02/Flr	Flat_2B/3P_M4(2)	8
02/Flr	Flat_2B/4P_M4(2)	1
02/Flr	Flat_3B/4P_M4(2)	2
02/Flr	Flat_3B/5P_M4(2)	4
02/Flr: 21		
03/Flr	Flat_1B/2P_M4(2)	5
03/Flr	Flat_2B/3P_M4(2)	9
03/Flr	Flat_2B/4P_M4(2)	1
03/Flr	Flat_3B/4P_M4(2)	2
03/Flr	Flat_3B/5P_M4(2)	4
03/Flr: 21		
04/Flr	Duplex_2B/3P_M4(2)_Lower	5
04/Flr	Duplex_2B/4P_M4(2)_Lower	1
04/Flr	Flat_1B/2P_M4(2)	1
04/Flr	Flat_2B/3P_M4(2)	4
04/Flr	Flat_2B/4P_M4(2)	1
04/Flr	Flat_3B/4P_M4(2)	1
04/Flr	Flat_3B/5P_M4(2)	2
04/Flr: 15		
05/Flr	Duplex_2B/4P_M4(2)_Lower	3
05/Flr	Duplex_4B/8P_M4(2)_Lower	1
05/Flr	Flat_1B/2P_M4(2)	1
05/Flr: 5		
Grand total: 85		

Refuse Schedule		
Type	Volume	Litres
Wheelie bin - 1100 litre - Recycling	12.62 m³	12100
Wheelie bin - 1100 litre - Recycling Commercial	2.29 m³	2200
Wheelie bin - 1100 litre - Refuse	12.62 m³	12100
Wheelie bin - 1100 litre - Refuse Commercial	2.29 m³	2200

Cycle Spaces
Cycle Spaces
144

Commercial Area	
Name	Area
E_Restaurant	184 m²
E_Restaurant	85 m²
E_Restaurant	146 m²
E_Shop	165 m²
E_Shop	223 m²
Grand total: 5	802 m²

Deal Ground Unit Type

- Common_Circulation
- E_Restaurant
- Flat_1B/2P_M4(2)
- Flat_2B/3P_M4(2)
- Flat_2B/4P_M4(2)
- Flat_3B/4P_M4(2)
- Flat_3B/5P_M4(2)

Deal Ground Unit Type

- Common_Bike Store
- Common_Bin Store
- Common_Circulation
- Common_Entrance
- Common_Plant Room
- Common_Store
- E_Bins
- E_Restaurant
- E_Shop

Deal Ground Unit Type

- Common_Circulation
- Duplex_2B/3P_M4(2)_Lower
- Duplex_2B/4P_M4(2)_Lower
- Flat_1B/2P_M4(2)
- Flat_2B/3P_M4(2)
- Flat_2B/4P_M4(2)
- Flat_3B/4P_M4(2)
- Flat_3B/5P_M4(2)

1. All Dimensions in mm unless stated otherwise.
 2. Do not scale this drawing. All dimensions to be verified by the contractor before work is commenced.
 3. Architect to be notified immediately if any discrepancies are found.
 4. All shop drawings to be approved by Architect before work commences.
 5. All details to be in accordance with relevant British Standards and manufacturers recommendations and specification.
 6. This drawing is the property of Stolion Studio Ltd. copyright reserved. This drawing is not to be copied, reproduced, retained or disclosed to any unauthorised person either wholly or in part without the specific consent in writing of Stolion Studio.
 7. All work to be carried out by a competent contractor working, where appropriate, to an agreed method statement.
 8. Please note that all details shown on GAs are generated automatically by the computer software, and are not to be used for reference or construction.
 9. For all interface details, please refer to 1:5 drawings.
 10. This drawing is produced based on Survey information by others and Stolion Studio Ltd take no responsibility for the accuracy of this information.

Notes
 Please note that all details shown on GAs are generated automatically by the computer software, and are not to be used for reference or construction. For all interface details, please refer to 1:5 drawings.

Rev	Date	Description
D	11/07/2023	Reserved Matters Amendment
C	19/06/23	Reserved Matters Issue
B	03/05/23	Amendments
A	19/04/23	DRAFT Issue

Drawing Title: W_Block 6_Area Plans, 00_Flr-07_Flr	Scale: 1 : 500 @ A1
Project No.: 055	First Issue: 19/04/23
Project Name: Deal Ground and May Gurney	Status: S3
Project Address: Bracondale, Norwich	Drawing No.: 055- S3- D