

LOCATION PLAN

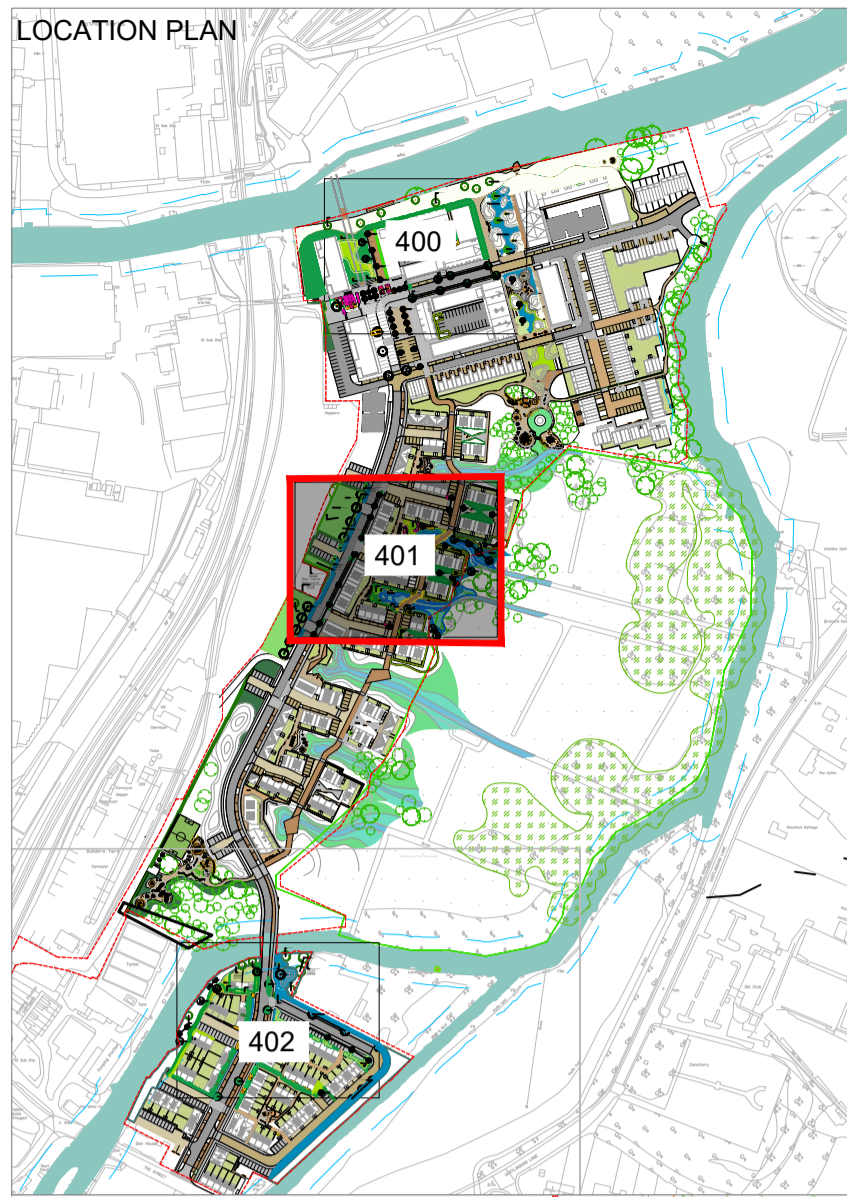

This drawing and the building works depicted are the copyright of IDP and may not be reproduced or amended except by written permission. No liability will be accepted for amendments made by other persons.

All dimensions to be checked on site and landscape architect notified of any discrepancies prior to commencement.

do not scale.

NOTES:

- 1.0 Do not scale from drawing, use figured dimensions only.
- 1.1 This drawing to be read in conjunction with all other IDP drawings and specifications.
- 1.2 Information shown on these drawings is not valid for Construction. Please refer to the status of the drawing in the Title and Issue box.
- 1.3 Do not procure or manufacture materials, or undertake construction site works from this drawing unless specifically noted as 'for construction'.
- 1.4 Any contractor that chooses to take forward this information for construction without full review process and approval does so at their own risk.
- 1.5 All measurements are to be checked on site prior to construction.
- 1.6 Where any conflict or inconsistency occurs between drawing and specification information the Contractor is to immediately notify IDP prior to continuing work.
- 1.7 Information to be read in conjunction with relevant drawing and specification information the Contractor is to immediately notify IDP prior to continuing work.

PLANTING NOTES

General

1. All planting and operations should comply with the latest version of BS 4428 'General Landscape Operations' and BS 3936 'Nursery Stock - Specification for Trees & Shrubs'.
2. All plants shall be supplied in accordance with the HTA National Plant Specification and from a HTA certified nursery, and in accordance with CPSE Code of Practice for Handling and Establishing Landscape Plants, Parts 1, 2 and 3.
3. All existing trees and hedges shall be surveyed and protected in accordance with BS 5837:2012, and temporary protection fencing erected for the duration of the construction period. Refer to arboricultural consultants drawings for location and details.
4. Specification of species, position and density shall be in accordance with drawing and planting notes provided, and should not be amended without prior approval of the Landscape Architect. For detailed landscape specification information, please refer to the relevant documentation accompanying this drawing.

Ground conditions/ Topsoil

5. All topsoil areas should be clear of rocks and rubble larger than 50mm diameter and any other debris that may interfere with the establishment of plants.
6. Improved topsoil to be multi-purpose grade and free of all contaminants, in accordance with the latest version of BS 3882:2015 Specification for Topsoil. Topsoil analysis should be undertaken and reported, with recommendations for improvements if below the standard for general landscape purposes.
7. Minimum topsoil depths should be as follows unless specified otherwise. Suitable (loosened) subsoil should provide the remainder of the rooting depths as required, and mixed with peak-free compost. Subsoil preparation shall be in accordance with BS 8601 and BS 4428 and scarified (rippled) to a suitable depth prior to spreading of topsoil. Any weeds/grass growth to be sprayed with appropriate herbicide at least 10 days prior to cultivation.
 - Ornamental shrubs 450mm;
 - native shrubs 300mm;
 - seedbed grass 100mm;
 - wildflower grass 50mm, or directly into existing ground;
 - tree pits to be excavated to at least twice the diameter of the root spread and 1.5 times the depth of the roots to be planted.

Cultivation

8. Planting outside the usual October-March dormant season shall be pursued by approval only if agreed all bare root plants shall be substituted with container grown stock, with additional establishment watering.
9. Plants shall be bedded in random fashion to avoid formal regimented lines or densities indicated in the schedule, except for specimens, which are to be planted in locations shown on the drawing. For mixes, shrubs should be planted in blocks, perennials & grasses should be planted in groups of 4 to 6. Please note: taller plant species to be planted to the rear with lower species to the front.
10. All planting should be watered in to field capacity immediately after planting and mulched with minimum of 50mm depth of medium grade crushed mulch. Where necessary, plants to be protected with rabbit fence and/or individual rabbit guard securely fixed to timber stakes.

Trees & Foundations

11. All trees to be supplied, planted and established in accordance with BS 8545. Trees adjacent to buildings and services shall include root barriers where necessary and should be planted in positions as indicated on the drawing.
12. All foundation designs provided by the architect/engineer must consider the effect of existing trees, and the proposed landscape scheme in accordance with the NHC Standards. Every effort has been made in the design to follow advice in Chapter 4.2 of the Standards, however landscape proposals should be referred to a structural engineer for checks and any conflicts made known to the Landscape Architect for necessary changes.
13. The contractor is responsible for checking locations of all existing and proposed services, and shall advise the Landscape Architect if there are any conflicts.
14. Trees with overhanging or highways visibility splays shall be clear stem to 2m high unless specified otherwise.

Maintenance

15. Management operations for the site shall be carried out as detailed in the agreed maintenance schedules at regular intervals, in accordance with any agreed Landscape Management Plan.
16. Any tree or plant which, within a period of 5 years from the implementation, dies, is removed or becomes seriously damaged or diseased, shall be replaced in the next planting season with another of a similar size and species unless otherwise agreed with the Local Planning Authority.

- Site Boundary
- Proposed specimen tree
- Proposed evergreen/deciduous specimen shrubs
- Clipped deciduous/evergreen hedgerows
- Deciduous/evergreen ornamental shrubs
- Broadleaf woodland mix
Indicative species: Acer pseudoplatanus, Betula pubescens, Corylus avellana, Crataegus monogyna, Ilex aquifolium, Salix caprea, Populus tremula, Prunus avium, Quercus robur, Betula pendula
- Woodland wet edge mix
Indicative species: Cornus sanguinea, Crataegus monogyna, Prunus spinosa, Rhamnus cathartica, Rhamnus fraxinea, Salix caprea, Salix viminalis
- Edible fruiting shrub mix
Indicative species: Ribes cereum, Ribes vicia-cristata, Ribes rubrum, Ribes nigrum, Fragaria x ananassa
- Native shrub mix
Indicative species: Viburnum opulus, Sorbus aucuparia, Rosa canina, Rosa arvensis, Viburnum lantana, Ilex aquifolium, Cytisus scoparius, Cornus sanguinea
- Proposed woodland understory mix:
Indicative species: Ligustrum vulgare, Crataegus monogyna, Corylus avellana, Viburnum opulus, Sambucus nigra, Viburnum lantana, Rhamnus cathartica, Taxus baccata, Acer campestre
- Fenn Habitat A
Translocated turf/marginal aquatic mix
Indicative mix species: Phragmites australis, Ranunculus lingua, Lysimachia vulgaris, Carex paniculata, Carex acuta
- Fenn Habitat B
Translocated turf/marginal aquatic mix
Indicative mix species: Lysimachia vulgaris, Juncus effusus, Ilex pseudocornus, Spergularia ulmaria, Carex nigra, Carex palustris, Agrostis medeolens
- Amenity turf grass
Rollax Madison turf
- Strong lawn mix:
Boston Seeds BS Eco-Clover Grass Seed, sowing rate 25g/m²

Code	Abbreviation	Species	Quantity	Height	Color	Quantity
1	Ace cam	Acer campestre	1	425-600mm	14-16cm	Counted
2	Ace gri	Acer glabrum	1	200-300mm	9-10cm	Counted
3	Aln glu	Alnus glutinosa	1	400-600mm	14-16cm	Counted
4	Bet nig	Betula nigra	1	400-600mm	14-16cm	Counted
5	Bet uti	Betula utilis	1	400-600mm	14-16cm	Counted
6	Car bet	Cornus betulinifolia	1	400-600mm	14-16cm	Counted
7	Car ave	Cornus avellana	1	400-600mm	14-16cm	Counted
8	Car syl	Cornus sylvestris	1	400-600mm	14-16cm	Counted
9	Car spi	Cornus spiralis	1	400-600mm	14-16cm	Counted
10	Ham mol	Hamamelis mollis	1	200-300mm	9-10cm	Counted
11	Phy opu	Physalis opulifolia	1	200-300mm	9-10cm	Counted
12	Phy opu D	Physalis opulifolia	1	200-300mm	9-10cm	Counted
13	Phy opu D G	Physalis opulifolia	1	200-300mm	9-10cm	Counted
14	Phy opu D G	Physalis opulifolia	1	200-300mm	9-10cm	Counted
15	Phy opu D G	Physalis opulifolia	1	200-300mm	9-10cm	Counted
16	Phy opu D G	Physalis opulifolia	1	200-300mm	9-10cm	Counted
17	Phy opu D G	Physalis opulifolia	1	200-300mm	9-10cm	Counted
18	Phy opu D G	Physalis opulifolia	1	200-300mm	9-10cm	Counted
19	Phy opu D G	Physalis opulifolia	1	200-300mm	9-10cm	Counted
20	Phy opu D G	Physalis opulifolia	1	200-300mm	9-10cm	Counted
21	Phy opu D G	Physalis opulifolia	1	200-300mm	9-10cm	Counted
22	Phy opu D G	Physalis opulifolia	1	200-300mm	9-10cm	Counted
23	Phy opu D G	Physalis opulifolia	1	200-300mm	9-10cm	Counted
24	Phy opu D G	Physalis opulifolia	1	200-300mm	9-10cm	Counted
25	Phy opu D G	Physalis opulifolia	1	200-300mm	9-10cm	Counted
26	Phy opu D G	Physalis opulifolia	1	200-300mm	9-10cm	Counted
27	Phy opu D G	Physalis opulifolia	1	200-300mm	9-10cm	Counted
28	Phy opu D G	Physalis opulifolia	1	200-300mm	9-10cm	Counted
29	Phy opu D G	Physalis opulifolia	1	200-300mm	9-10cm	Counted
30	Phy opu D G	Physalis opulifolia	1	200-300mm	9-10cm	Counted
31	Phy opu D G	Physalis opulifolia	1	200-300mm	9-10cm	Counted
32	Phy opu D G	Physalis opulifolia	1	200-300mm	9-10cm	Counted
33	Phy opu D G	Physalis opulifolia	1	200-300mm	9-10cm	Counted
34	Phy opu D G	Physalis opulifolia	1	200-300mm	9-10cm	Counted
35	Phy opu D G	Physalis opulifolia	1	200-300mm	9-10cm	Counted
36	Phy opu D G	Physalis opulifolia	1	200-300mm	9-10cm	Counted
37	Phy opu D G	Physalis opulifolia	1	200-300mm	9-10cm	Counted
38	Phy opu D G	Physalis opulifolia	1	200-300mm	9-10cm	Counted
39	Phy opu D G	Physalis opulifolia	1	200-300mm	9-10cm	Counted
40	Phy opu D G	Physalis opulifolia	1	200-300mm	9-10cm	Counted
41	Phy opu D G	Physalis opulifolia	1	200-300mm	9-10cm	Counted
42	Phy opu D G	Physalis opulifolia	1	200-300mm	9-10cm	Counted
43	Phy opu D G	Physalis opulifolia	1	200-300mm	9-10cm	Counted
44	Phy opu D G	Physalis opulifolia	1	200-300mm	9-10cm	Counted
45	Phy opu D G	Physalis opulifolia	1	200-300mm	9-10cm	Counted
46	Phy opu D G	Physalis opulifolia	1	200-300mm	9-10cm	Counted
47	Phy opu D G	Physalis opulifolia	1	200-300mm	9-10cm	Counted
48	Phy opu D G	Physalis opulifolia	1	200-300mm	9-10cm	Counted
49	Phy opu D G	Physalis opulifolia	1	200-300mm	9-10cm	Counted
50	Phy opu D G	Physalis opulifolia	1	200-300mm	9-10cm	Counted

ARCHITECTURE
URBAN DESIGN & MASTERPLANNING
LANDSCAPE & ENVIRONMENT

status: **PLANNING** RIBA Stage: **3**

client: **Serrys Property**

job: **Deal Ground and May Gurney**

title: **Soft Landscape Proposals 2 of 3**

drawn: **LK** date: **16.06.23**

checked: **PS** scale: **@ 1:1200**

job no: **LA5589** drg no: **401** rev: **A**

IDP GROUP 27 SPON STREET COVENTRY CV1 3BA
T: +44 (0)24 7652 7600 E: info@idpgroup.com
www.idpgroup.com